

[330_{v2}] Gerflor Acoustic 15 dB

CONDITIONS

SUBSTRATES

ACCESSORIES

INSTALLATION

LAYING CONDITIONS

AUTHORIZED FLOOR COVERINGS		Creation 30-40-55 solid clic, Creation 70 Clic, Senso Clic, Senso Clic Premium, Rigid 30 Lock, Senso 20 lock, depending on the type of premises (see installation guidelines of the floor covering).
SUBSTRATE EVENNESS	Flatness requirement: < 5 mm / 2 metre ruler and < 1 mm / 20 cm ruler	Flat, clean, sound, dry and solid substrate.
STORAGE	At least 24 hours prior to installation	Store the underlayer in the room where it is going to be laid.
LAYING TEMPERATURE	Refer to installation guidelines of the associated floor covering	Ideally 20°C.
PERIMETER EXPANSION GAP	Refer to installation guidelines of the associated floor covering	Around the edges of the room, fixed objects and door frames. The gap must be covered by a finishing profile.
DIVISIONS	Refer to installation guidelines of the associated floor covering	Each closed room or premises must be considered separately.
DIRECT SUNLIGHT (SUNNY AREAS, BAY WINDOWS, SKYLIGHTS, SKYDOMES, ETC.)	Refer to installation guidelines of the associated floor covering	
VERANDA/CONSERVATORY	Prohibited	Prohibited, irrespective of the substrate.
FIRST USE	Immediately after installation	

USAGE CONDITIONS

USAGE TEMPERATURE	Refer to installation guidelines of the associated floor covering	
STATIC LOADS	< 30 kg/cm ² and < 200 kg/support	Do not use rubber end caps. Use flat (not tapered) end caps without any pattern that are suitable for PVC. Use end caps on furniture legs.
CASTOR CHAIRS	PVC-compatible castors according to EN 12529	Recommendation: protective mat beneath castor chairs.

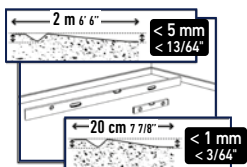

SUBSTRATE EVENNESS

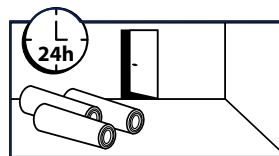

STORAGE

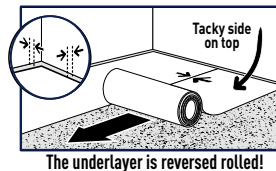

The underlayer is reversed rolled!

PERIMETER EXPANSION GAP

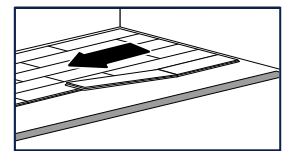

FLOOR COVERING INSTALLATION

[330_{v2}] Gerflor Acoustic 15 dB

CONDITIONS	SUBSTRATES	ACCESSORIES	INSTALLATION
------------	-------------------	-------------	--------------

SUBSTRATE		CONDITIONS For installing this floor covering
Concrete floor, painted concrete, levelling compound, cement based screed, anhydrite (calcium sulphate)-based screed	✓	Moisture content: Cement based substrate: < 7 % CCM, 92 % RH - Anhydrite-based substrate: < 1 % If necessary, prepare the support and apply a smoothing compound to eliminate any irregularities
Ceramic tiles	✓	Check the joint width and depth allowed in the Installation Guidelines of the associated flooring. If the width and depth are greater, apply a grouting or levelling compound
Glued compact PVC / rubber / linoleum floor coverings	✓	After examination and repair depending on the condition of the floor covering. If more than 10% is in bad condition, complete removal is necessary followed by new substrate preparation
Foam backed PVC floor coverings	✗	Prohibited
Textile floor covering (carpet) / textile-backing PVC floorings	✗	Prohibited
Vinyl asbestos tiles	✓	Refer to Gerflor's Technical Guide for Overlaying Asbestos Floors
Glued parquet / laminated floor /floating parquet or wood based panels	✗	Prohibited
OSB	!	Apply a fiber-reinforced levelling compound after treatment of any unevenness and joints between panels
Wood-based panel flooring on joists or battens / parquet nailed on battens ventilated underneath	✓	After treatment of any possible defects on the substrate (unevenness, open joints between planks or panels).
Water reversible underfloor heating	✓	Allowed
Underfloor heating with circulating water, max temperature 28°C	✓	Allowed
Radiant electric underfloor heating	!	Gluing mandatory

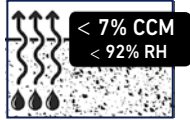

The preparation of the substrate must comply with the current relevant standards in the country of use. For any information on product properties and usages, please refer to its technical datasheet: www.gerflor.com.

[330_{v2}] Gerflor Acoustic 15 dB

CONDITIONS

SUBSTRATES

ACCESSORIES

INSTALLATION

TOOLS

Cutter - Tape measure - Metal ruler

DIVISIONS

FIX&FREE 100 and ROMUS accessories

JOINING OF UNDERLAYER STRIPS

Single-sided adhesive tape/masking tape, with a thickness < 0.2 mm.

FINISHES

Skirting Design - Ref. : 6086 / Skirting Design - MDF - Ref. : 5947 – See Installation Guidelines [504A] and [504B]

Door threshold: refer to Romus catalogue

[330_{v2}] Gerflor Acoustic 15 dB

CONDITIONS

SUBSTRATES

ACCESSORIES

INSTALLATION



The floor covering should be examined prior to installation for any visible defects. The flooring must belong to the same production batch. If there are any visible defects, please notify GERFLOR and do not begin installation without its prior approval.

LAYING FLAT

- Unroll the underlayer with the fibre or felt side facing down on the floor in the same direction as the planks/tiles.

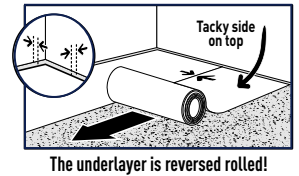

- Stretch and flatten the underlayer by hand

- Perimeter expansion gap: at room edges, fixed objects and door threshold. The gap must be covered by a finishing profile. Refer to installation guidelines of the associated floor covering.

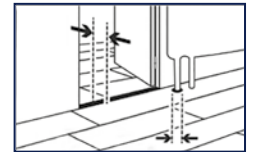
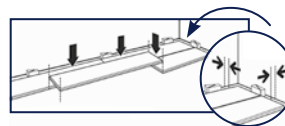

- Position the underlayer strip edge to edge.

- If necessary, divide the laying (see installation guidelines of the associated floor covering.)

- Join the underlay strips and the end-to-end joints with a single-sided adhesive tape/ masking tape with a thickness <0.2 mm.

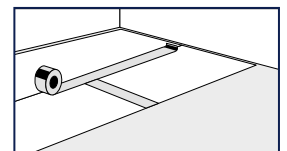

[330_{v2}] Gerflor Acoustic 15 dB

CONDITIONS

SUBSTRATES

ACCESSORIES

INSTALLATION

INSTALLATION AND CUTTING OUT

- Cut the underlayer along the walls or existing skirtings. Leave a perimeter expansion gap suitable for the associated floor covering (see installation guidelines of the floor covering).

- **Tiles/planks must be laid in the same direction as the underlayer.** Avoid laying underlay joints and plank/tile joints side-by-side.

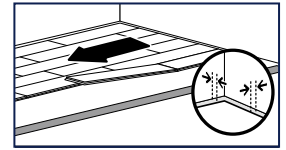

- Install tiles/planks in compliance with the associated installation guidelines.

- In case of division, the division of the planks/tiles must match that of the underlayer.